

AGM käynnistysakut



- AGM-tekniikka
- Tiivis, vuotamaton rakenne ja asentovapaa AGM-akku
- Hyväksytty akku "Start-Stop" -tekniikalla varustettuihin autoihin

Kuvaus

AGM-akku kalsium-kalsium -tekniikalla on starttiakkukehityksen huipputuote. Suunniteltu erityisesti ajoneuvoihin, jotka ovat varustettuja "Start-Stop" -tekniikalla. AGM-sarja tarjoaa neljä kertaa enemmän starttisyklejä kuin perinteinen starttiakku.

Tilausnumerot

Tilausnumero	Jännite	Virta Ah	CCA	Mitat			Paino kg	Napaisuus	Napa	Kiinnitys
	V			Pituus	Leveys	Korkeus				
D26L AGM	12	75	750SAE	260	172	220	19,7	0	T1	B1
D26R AGM	12	75	750SAE	260	172	220	19,7	1	T1	B1
56020 AGM	12	60	680EN	242	175	190	16,9	0	T1	B3
57020 AGM	12	70	760EN	278	175	190	19,6	0	T1	B3
58020 AGM	12	80	800EN	315	175	190	22	0	T1	B3
59520 AGM	12	95	850EN	352	175	190	25	0	T1	B3
60520 AGM	12	105	950EN	393	175	190	28,5	0	T1	B3

Napaisuus

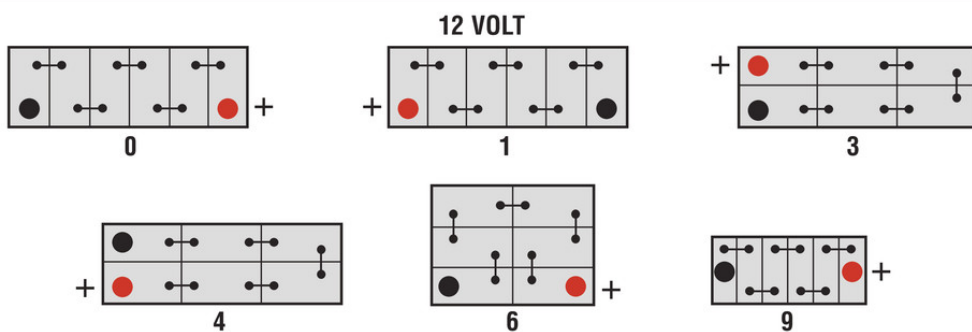

Asennustapa

N



B1

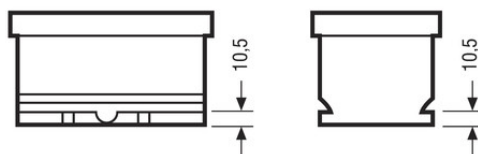

B3

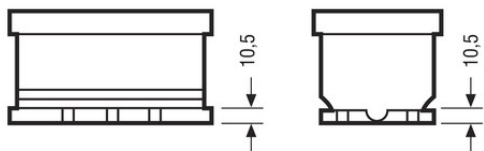

B5

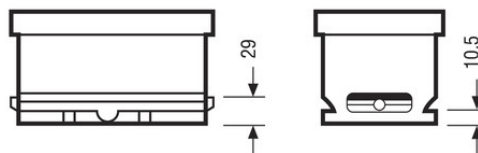

B3/B4 (B3 with Hold-Down adaptor 23288996)

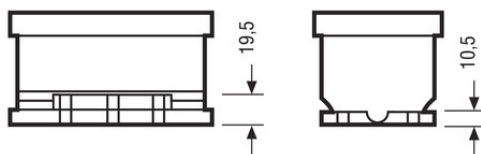

B12

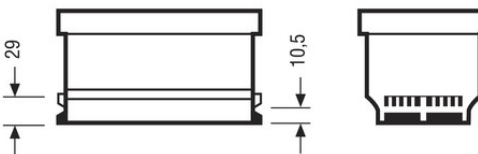

Napatyypit

T1 Standard DIN Post

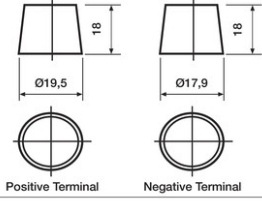

T3 Small Japanese JIS Terminal

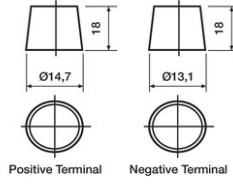

T4-F

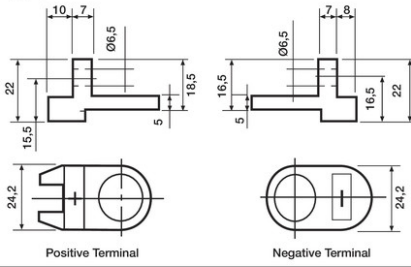

T4

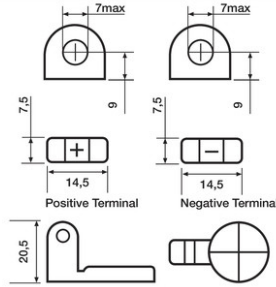

T9 Classic 702/703/721/722

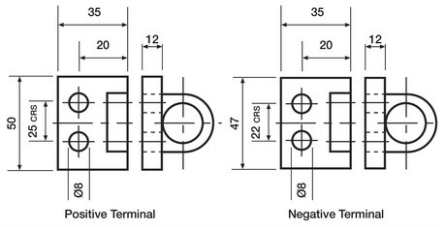

T8 Ford Cargo Terminal use adapter kit (order 23292114)

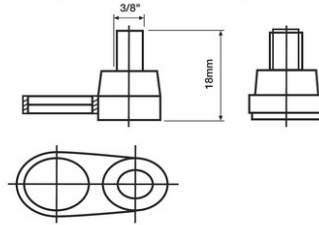

TM Marine Dual Terminals

